



WEISSENFELS



Chain Sling Components – Alloy Grade 80 and Grade 100

Self Locking “SL” Hook (G80)

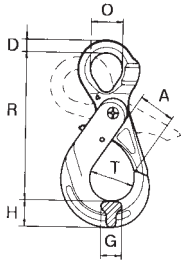

Stock No	Chain Size	WLL Lbs* Grade 80	Dimensions in Inches							WT. EA. LBS
			A	D	G	H	O	R	T	
SL.07	9/32-5/16	4,500	1.06	0.39	0.67	0.83	1.02	4.41	1.42	1.21
SL.10	3/8	7,100	1.50	0.51	0.9	1.06	1.30	5.94	1.81	2.47
SL.13	1/2	12,000	1.81	0.63	1.10	1.34	1.65	7.28	2.36	4.89
SL.16	5/8	18,100	2.24	0.71	1.26	1.69	2.05	9.06	2.95	8.80

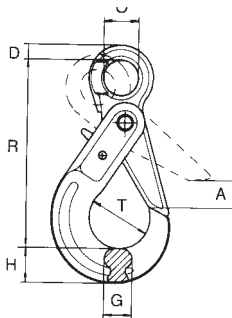

Self Locking “SNE” Hook (G100)

Stock No	Chain Size	WLL Lbs* Grade 100	Dimensions in Inches							WT. EA. LBS
			A	D	G	H	O	R	T	
SNE.06.10	1/4(6MM)	3,050	1.10	0.43	0.63	0.83	0.83	4.29	1.38	1.12
SNE.078.10	9/32-5/16	5,700	1.34	0.47	0.79	1.02	0.98	5.31	1.69	2.06
SNE.10.10	3/8	8,800	1.77	0.63	0.98	1.18	1.30	6.61	2.20	3.58
SNE.13.10	1/2	15,000	2.01	0.79	1.38	1.57	1.57	8.07	2.72	5.95
SNE.16.10	5/8	22,600	2.36	1.06	1.42	1.97	1.97	9.88	3.15	13.33

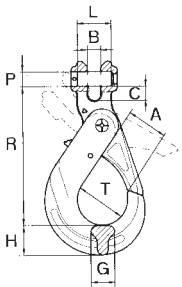

Self Locking “SC” Hook (G80)

Stock No	Chain Size	WLL Lbs* Grade 80	Dimensions in Inches								WT. EA. LBS
			A	B	C	G	H	R	T	PXL	
SC.07	9/32	4,500	1.08	0.35	0.39	0.67	0.83	3.74	1.42	.35x.89	1.19
SC.10	3/8	7,100	1.50	0.47	0.55	0.87	1.06	4.92	1.81	.51x1.24	2.58
SC.13	1/2	12,000	1.81	0.59	0.67	1.10	1.34	6.18	2.36	.63x1.65	5.95
SC.16	5/8	18,100	2.24	0.75	0.79	1.26	1.69	7.44	2.95	.83x2.03	9.03

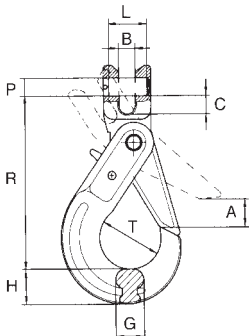

Self Locking “SNC” Hook (G100)

Stock No	Chain Size	WLL Lbs* Grade 100	Dimensions in Inches								WT. EA. LBS
			A	B	C	G	H	R	T	PXL	
SNC.06	1/4(6MM)	3,050	1.10	0.28	0.31	0.63	0.83	3.70	1.38	.29x.69	1.09
SNC.078	9/32-5/16	5,700	1.34	0.35	0.39	0.79	1.02	4.84	1.69	.35x.89	2.06
SNC.10	3/8	8,800	1.77	0.47	0.55	0.98	1.18	5.63	2.20	.51x1.24	3.48
SNC.13	1/2	15,000	2.01	0.59	0.67	1.38	1.57	7.09	2.72	.63x1.65	5.95
SNC.16	5/8	22,600	2.36	0.75	0.75	1.42	1.97	8.46	3.15	.83x2.03	13.11